

Forged Steel Valve



Address: Binhai ETDZ, 5 Road, Longwan, Wenzhou, China. 325000
Tel: +86 577 8663 2750
Fax: +86 577 8663 2850

Mob./WhatsApp: +86 173 5771 5577
www.flowvalvefitting.com
Info@flowvalvefitting.com



WhatsApp Code

FVF BRAND, RELIABLE QUALITY FOR YOU
CE&ISO 9001:2015 CERTIFIED ACQUIRED
15 YEARS FLUID SOLUTION EXPERIENCES
EXPORTING TO OVER 40 COUNTRIES
EXCELLENT VALUE-ADDED SERVICE.

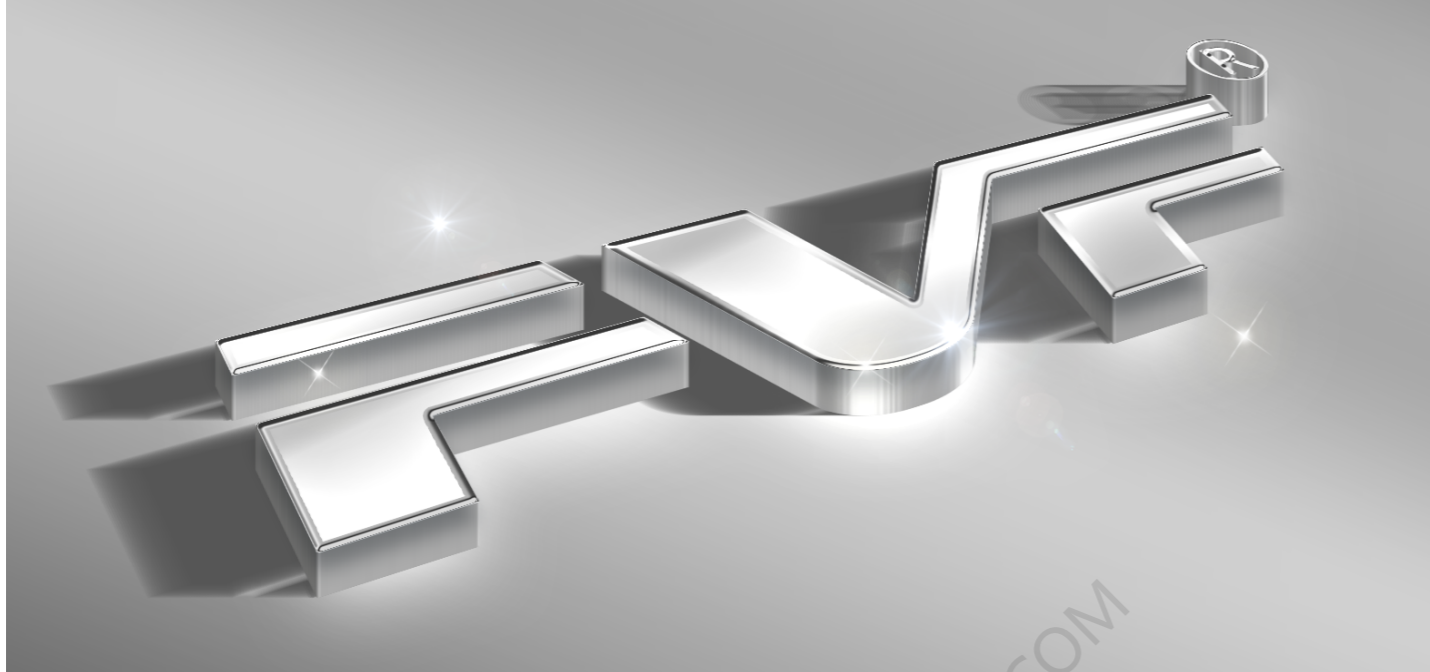

We focus on Details
We Make Different
FVF Brand, that can be trust.

FVF Brand Found in year 2010, we specialize in Manufacturing Various Lined Valves, Multi-Port Ball Valve, Control Valves and Pipe Fittings.

The products are mainly widely used in modern anti-corrosion engineering fields such as Lithium Battery, petroleum, chemical industry, pharmacy, printing and dyeing, electrical engineering, ship building, metallurgy, military industry, semiconductor chemistry, electronic phosphoric acid, etc.

Through the years, "Perfection" has been the only goal we pursue. In order to satisfy customers, with continuous efforts, we are working towards perfection through a Quality Assurance System. With over ten years Exporting Experiences, we have the confident to give you best support from pre-sales to after-sales Service.

FVF Product Line:

Lined Valves (Lined Butterfly Valve, Lined Ball Valve, Lined Diaphragm Valve etc.)

Ceramic Valves (Ceramic Ball Valve, Ceramic Gate Valve, Ceramic Butterfly Valve etc.)

Pneumatic Valves (Pneumatic Butterfly Valve, Ball Valve etc.)

Electric Valves (Electric Butterfly Valve, Ball Valve etc.)

Multi-Port Ball Valve (3-Way Ball Valve, 4-Way Ball Valve, 5-Way Ball Valve)

Manual Valve (Check Valve, Gate Valve, Globe Valve etc.)

Pipe Fittings (150LBS Thread Pipe Fittings, Butt-Weld Fittings, 3000PSI Pipe Fittings)

Stainless Steel Flanges

FVF[®]
FVF TECHNOLOGY CO., LIMITED

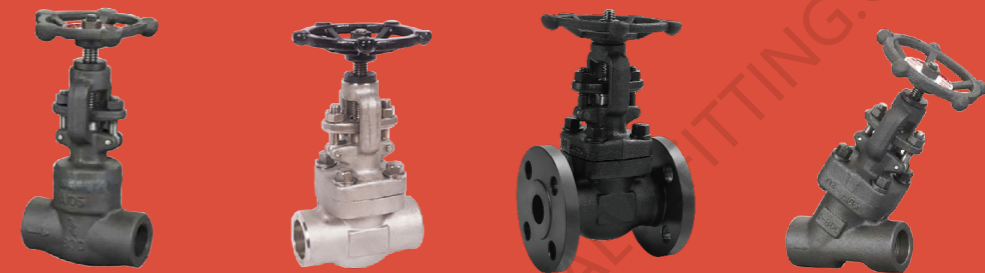

Forged Steel Globe Valve

Our Core Values: Team, Details, Altruism, Innovation and Embrace Change.

Forged Steel Globe Valve

FVF TECHNOLOGY CO., LIMITED



Female threaded and welded globe valve

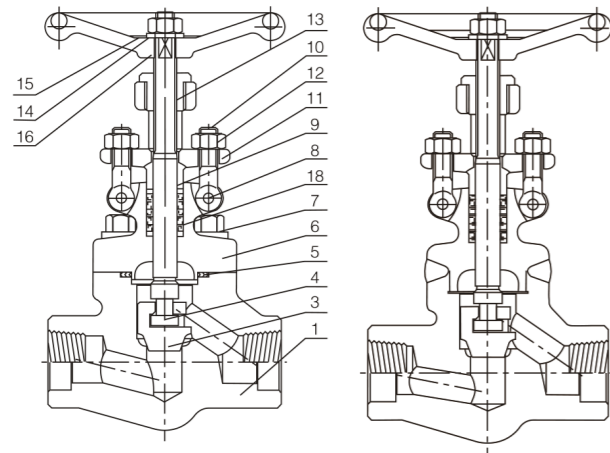

Application standards

- Design and manufacture conform to: BS 5352, MSS SP-18
- Connection ends conform to:
 - Socket welded ends conform to ANSI B16.11, JB/T1751
 - Screw ends conform to ANSI B1.20.1, JB/T7306
 - Butt-welded ends conform to ANSI B16.25, JB/T12224
 - Flange ends conform to ANSI B16.5, JB79
- Test and inspection conform to: API 598, GB/T13927, JB/T9092
- Structure features:
 - Bolted bonnet, outside screw and yoke
 - Welded bonnet, outside screw and yoke
- Materials conform to ANSI/ASTM
- Main materials: A105, LF2, F5, F11, F22, F304(L), F316(L), F347, F321, F51, Monel, Alloy 20# etc.

Carbon steel temperature-pressure rate

CL150-285PS.I @100 °F CL300-740PS.I @100 °F CL600-1480PS.I @100 °F CL800-1975PS.I @100° F CL1500-3705PS.I @100 °F

Material List of Main Parts

NO.	Part name	A105/F6a	A105/F6aHFS	LF2/304	F11/F6aHF	F304(L)/304(L)	F316(L)/316(L)	F51/F51
1	Body	A105	A105+HF	LF2	F11+HF	F304(L)	F316(L)	F51
3	Disc	F6a	F6a	F304	F6aHF	F304(L)	F316(L)	F51
4	Stem	410	410	304	410	304(L)	316(L)	F51
5	Gasket	304 + Flexible graphite	304 + Flexible graphite	304 + Flexible graphite	304 + Flexible graphite	304 + Flexible graphite	304 + Flexible graphite	304 + Flexible graphite
6	Bonnet	A105	A105	LF2	F1 1	F304(L)	F316(L)	F51
7	Bolt	B7	B7	F7	B16	B8(M)	B8(M)	B8(M)
8	Pin	410	410	410	410	304	304	304
9	Gland	410	410	304	410	304	316	F51
10	Gland eyebolt	B7	B7	L7	B16	B8(M)	B8(M)	B8(M)
11	Gland flange	A105	A105	LF2	F11	F304	F304	F304
12	Hex nut	2H	2H	2H	2H	8(M)	8(M)	8(M)
13	Stem nut	410	410	410	410	410	410	410
14	Locking nut	35	35	35	35	35	35	35
15	Nameplate	AL	AL	AL	AL	AL	AL	AL
16	Handwheel	A197	A197	A197	A197	A197	A197	A197
18	Packing	Graphite	Graphite	Graphite	Graphite	Graphite	Graphite	Graphite

Forged Steel Globe Valve

FVF TECHNOLOGY CO., LIMITED



Female threaded and welded globe valve

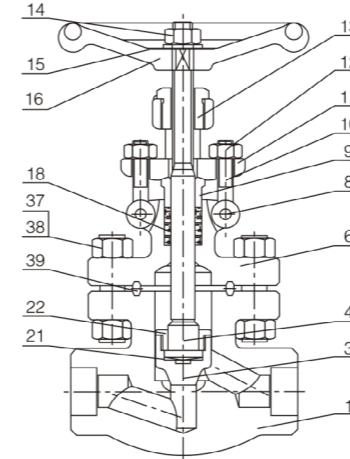

Application standards

- Design and manufacture conform to: BS 5352, MSS SP-18
- Connection ends conform to:
 - Socket welded ends conform to ANSI B16.11, JB/T1751
 - Screw ends conform to ANSI B1.20.1, JB/T7306
 - Butt-welded ends conform to ANSI B16.25, JB/T12224
 - Flange ends conform to ANSI B16.5, JB79
- Test and inspection conform to: API 598, GB/T13927, JB/T9092
- Structure features:
 - Bolted bonnet, outside screw and yoke
 - Welded bonnet, outside screw and yoke
- Materials conform to ANSI/ASTM
- Main materials: A105, LF2, F5, F11, F22, F304(L), F316(L), F347, F321, F51, Monel, Alloy 20# etc.

Carbon steel temperature-pressure rate

CL150-285PS.I @100 °F CL300-740PS.I @100 °F CL600-1480PS.I @100 °F CL800-1975PS.I @100° F CL1500-3705PS.I @100 °F

Material List of Main Parts

NO.	Part name	A105/F6a	A105/F6aHFS	LF2/304	F11/F6aHF	F304(L)/304(L)	F316(L)/316(L)	F51/F51
1	Body	A105	A105+HF	LF2	F11+HF	F304(L)	F316(L)	F51
3	Disc	F6a	F6a	F304	F6aHF	F304(L)	F316(L)	F51
4	Stem	410	410	304	410	304(L)	316(L)	F51
6	Bonnet	A105	A105	LF2	F11	F304(L)	F316(L)	F51
8	Pin	410	410	410	410	304	304	304
9	Gland	410	410	304	410	304	316	F51
10	Gland eyebolt	B7	B7	L7	B16	B8(M)	B8(M)	B8(M)
11	Gland flange	A105	A105	LF2	F11	F304	F304	F304
12	Hex nut	2H	2H	2H	2H	8(M)	8(M)	8(M)
13	Stem nut	410	410	410	410	410	410	410
14	Locking nut	35	35	35	35	35	35	35
15	Nameplate	AL	AL	AL	AL	AL	AL	AL
16	Handwheel	A197	A197	A197	A197	A197	A197	A197
18	Packing	Graphite	Graphite	Graphite	Graphite	Graphite	Graphite	Graphite
21	Stem pad	420	420	420	420	316SH	316SH	316SH
22	Disc nut	410	410	410	410	410	410	410
37	Screwed stud	B7	B7	L7	B16	B8(M)	B8(M)	B8(M)
38	Nut	2H	2H	8	8	8(M)	8(M)	8(M)
39	Metal ring	304	304	304	304	304(L)	316(L)	F51

Forged Steel Globe Valve

FVF TECHNOLOGY CO., LIMITED



Pressure seal globe valve

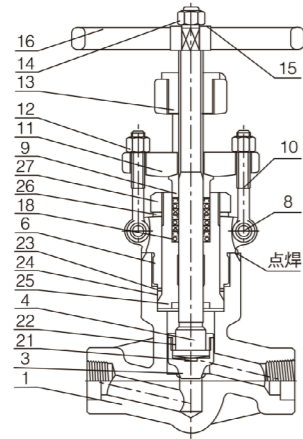

Application standards

- Design and manufacture conform to ASME B16.34
- Connection ends conform to:
 - Socket welded ends conform to ANSI B16.11, JB/T1751
 - Screw ends conform to ANSI B1.20.1, JB/T7306
 - Butt-welded ends conform to ANSI B16.25, JB/T12224
 - Flange ends conform to ANSI B16.5, JB79
- Test and inspection conform to: API 598, GB/T13927, JB/T9092
- Structure features: Thread and pressure seal bonnet
- Materials conform to ANSI/ASTM
 - Main materials: A105, LF2, F5, F11, F22, F304(L), F316(L), F347, F321, F51, Monel, Alloy 20# etc.

Carbon steel temperature-pressure rate

CL1500-3705.P.S.I @100 °F CL2500-6170.P.S.I @100 °F

Material List of Main Parts

NO.	Part name	A105/F6a	A105/F6aHFS	LF2/304	F11/F6aHF	F304(L)/304(L)	F316(L)/316(L)	F51/F51
1	Body	A105	A105+HF	LF2	F11+HF	F304(L)	F316(L)	F91 +HF
3	Disc	410	410	304	410	304(L)	316(L)	410+HF
4	Stem	410	410	304	410	304(L)	316(L)	410
6	Bonnet	A105	A105	LF2	F11	F304(L)	F316(L)	F91
8	Pin	410	410	410	410	304	304	410
9	Gland	410	410	304	410	304	316	410
10	Gland eyebolt	B7	B7	L7	B16	B8(M)	B8(M)	B8
11	Gland	A105	A105	LF2	F11	F304	F304	F91
12	Hex nut	2H	2H	2H	2H	8(M)	8(M)	8
13	Stem nut	410	410	410	410	410	410	410
14	Locking nut	35	35	35	35	35	35	35
15	Nameplate	AL	AL	AL	AL	AL	AL	AL
16	Handwheel	A197	A197	A197	A197	A197	A197	A197
18	Packing	Graphite	Graphite	Graphite	Graphite	Graphite	Graphite	Graphite
21	Stem pad	420	420	420	420	316SH	316SH	420
22	Disc nut	410	410	410	410	304(L)	316(L)	410
23	Sea ring gasket	420	420	304	304	304(L)	316(L)	316(L)
24	P.S. ring	304	304	304	304	304	316	304
25	P.S. seat	420	420	304	304	304(L)	316(L)	F91
26	P.S. seat	410	410	410	410	410	410	410
27	Draw- in stud	Cast steel	Cast steel	Cast steel	Cast steel	Stainless steel	Stainless steel	Cast steel

Forged Steel Globe Valve

FVF TECHNOLOGY CO., LIMITED



Female threaded and welded globe valve

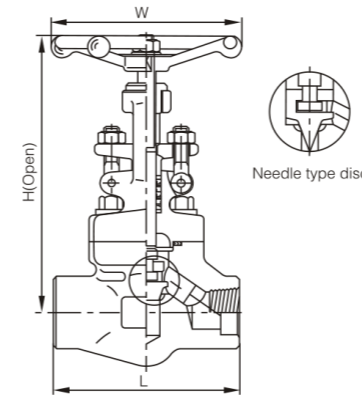

CL800

Bolted bonnet, full port & reduced port, outside screw and yoke(OS & Y) Threaded, butt-welded or socket welded ends, design to BS5352

Specification (NPS)	R.P	-	1/2	3/4	1	1¼	1½	2	2½	3
	F.P	1/4	3/8	1/2	3/4	1	1¼	1½	2	2½
Face to face(mm)	L	79	79	92	111	120	152	172	200	-
Handwheel diameter (mm)	W	100	100	100	125	160	160	180	200	-
Height(open)(mm)	H	164	164	164	203	224	260	300	355	-
Flow port dimension (mm)	d	7	9	13	17.5	23	30	35	46	-
Weight(kg)		1.9	2.28	2.37	4.3	5.75	7.8	12.5	17.5	-

CL800

Welded bonnet, full port & reduced port outside screw and yoke(OS & Y) Threaded, butt-welded or socket welded ends, design to BS5352

Specification (NPS)	R.P	-	1/2	3/4	1	1¼	1½	2	2½	3
	F.P	1/4	3/8	1/2	3/4	1	1¼	1½	2	2½
Face to face(mm)	L	79	79	92	111	120	152	172	200	-
Handwheel diameter (mm)	W	100	100	100	125	160	160	180	200	-
Height(open)(mm)	H	164	164	164	203	224	260	300	355	-
Flow port dimension (mm)	d	7	9	13	17.5	23	30	35	46	-
Weight(kg)		1.7	1.7	1.9	3.3	5.2	6.8	10.6	13.8	-

CL900-CL1500

Bolted bonnet, full port & reduced port , outside screw and yoke(OS & Y) Threaded, butt-welded or socket welded ends, design to BS5352

Specification (NPS)	R.P	-	1/2	3/4	1	1¼	1½	2	2½	3
	F.P	1/4	3/8	1/2	3/4	1	1¼	1½	-	-
Face to face(mm)	L	92	111	111	120	152	172	220	-	-
Handwheel diameter (mm)	W	100	125	125	160	160	180	200	-	-
Height(open)(mm)	H	171	207	207	240	258	330	355	-	-
Flow port dimension (mm)	d	7	12	15	20	28	32	40	-	-
Weight(kg)		2.3	3.7	3.6	3.6	7.6	11.6	15	-	-

Forged Steel Globe Valve

FVF TECHNOLOGY CO., LIMITED



Female threaded and welded globe valve

CL900-CL1500 Welded bonnet, full port & reduced port, outside screw and yoke(OS & Y)
Threaded, butt-welded or socket welded ends, design to BS5352

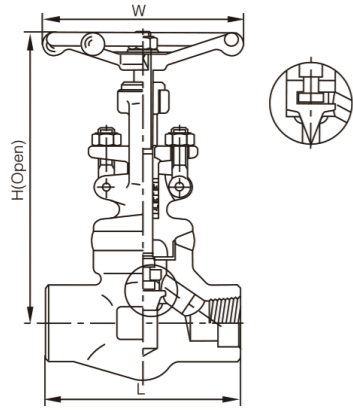

Specification (NPS)	R.P	-	1/2	3/4	1	1¼	1½	2	2½	3
	F.P	1/4	3/8	1/2	3/4	1	1¼	1½	-	-
Face to face(mm)	L	92	111	111	120	152	172	220	-	-
Handwheel diameter (mm)	W	100	125	125	160	160	180	200	-	-
Height(open)(mm)	H	171	207	207	240	258	330	355	-	-
Flow port dimension (mm)	d	7	12	15	20	28	32	40	-	-
Weight(kg)		2.0	3.4	3.3	6.0	5.6	10.3	14.2	-	-

CL900-CL1500 Pressure seal bonnet, full port, outside screw and yoke(OS & Y)
Threaded, butt-welded or socket welded ends, design to BS5352

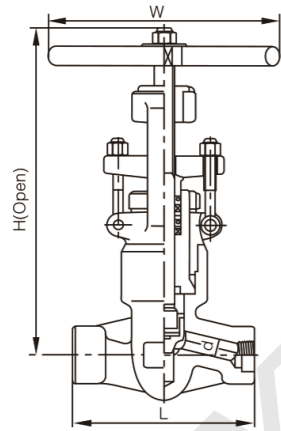

Specification (NPS)	F.P	1/2	3/4	1	1¼	1½	2	2½
Face to face(mm)	L	140	140	140	178	178	216	-
Handwheel diameter (mm)	W	220	200	200	280	280	300	-
Height(open)(mm)	H	320	320	320	440	440	490	-
Flow port dimension (mm)	d	12	15	20	28	32	40	-
Weight(kg)		11.5	10.8	10.5	19.6	21.1	55.4	-

CL2500 Pressure seal bonnet, full port, outside screw and yoke (OS & Y)
socket welded ends, design to ASME B16.34

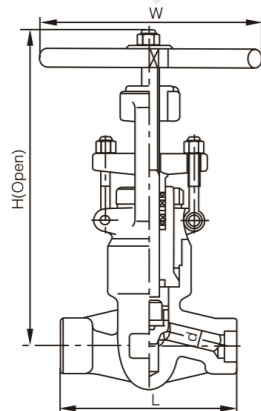

Specification (NPS)	F.P	1/2	3/4	1	1¼	1½	2	2½
Face to face(mm)	L	186	186	186	232	232	279	-
Handwheel diameter (mm)	W	200	200	200	280	280	300	-
Height(open)(mm)	H	375	378	380	490	490	540	-
Flow port dimension (mm)	d	11	14	19	25	28	35	-
Weight(kg)		12.3	11.6	10.8	26.0	28.4	60	-

Forged Steel Globe Valve

FVF TECHNOLOGY CO., LIMITED



Female threaded and welded Y type globe valve

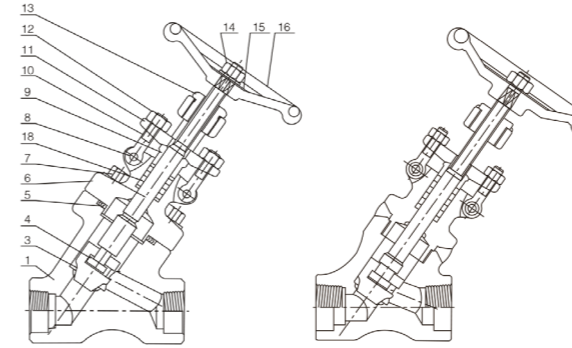

Carbon steel temperature-pressure rate

CL150-285PS.I @100 °F
CL300-740PS.i @100 °F
CL600-1480PS.I @100 °F
CL800-1975PS.i @100 °F
CL1500-3705PS.I @100 °F

Material List of Main Parts

NO.	Part name	A105/F6a	A105/F6aHFS	LF2/304	F11/F6aHF	F304(L)/304(L)	F316(L)/316(L)	F51/F51
1	Body	A105	A105+HF	LF2	F11+HF	F304(L)	F316(L)	F51
3	Disc	F6a	F6a	F304	F6aHF	F304(L)	F316(L)	F51
4	Stem	410	410	304	410	304(L)	316(L)	F51
5	Gasket	304 + Flexible graphite	304 + Flexible graphite	304 + Flexible graphite	304 + Flexible graphite	304 + Flexible graphite	304 + Flexible graphite	304 + Flexible graphite
6	Bonnet	A105	A105	LF2	F1 1	F304(L)	F316(L)	F51
7	Bolt	B7	B7	F7	B16	B8(M)	B8(M)	B8(M)
8	Pin	410	410	410	410	304	304	304
9	Gland	410	410	304	410	304	316	F51
10	Gland eyebolt	B7	B7	L7	B16	B8(M)	B8(M)	B8M
11	Gland flange	A105	A105	LF2	F11	F304	F304	F304
12	Hex nut	2H	2H	2H	2H	8(M)	8(M)	8(M)
13	Stem nut	410	410	410	410	410	410	410
14	Locking nut	35	35	35	35	35	35	35
15	Nameplate	AL	AL	AL	AL	AL	AL	AL
16	Handwheel	A197	A197	A197	A197	A197	A197	A197
18	Packing	Graphite	Graphite	Graphite	Graphite	Graphite	Graphite	Graphite

Application standards

- Design and manufacture conform to BS5352, MSS SP-118
- Connection ends conform to:
 - Socket welded ends conform to ANSI B16.11, JB/T1751
 - Screw ends conform to ANSI B1.20.1, JB/T7306
 - Butt-welded ends conform to ANSI B16.25, JB/T12224
 - Flange ends conform to ANSI B16.5, JB79
- Test and inspection conform to API 598, GB/T13927, JB/T9092
- Structure features:
 - Bolted bonnet, outside screw and yoke
 - Welded bonnet, outside screw and yoke
- Materials conform to ANSI/ASTM
 - A105, LF2, F5, F11, F22, F304(L), F316(L), F347, F321, F51, Monel, Alloy 20# etc.
- Main materials:

Forged Steel Globe Valve

FVF TECHNOLOGY CO., LIMITED



Y type globe valve

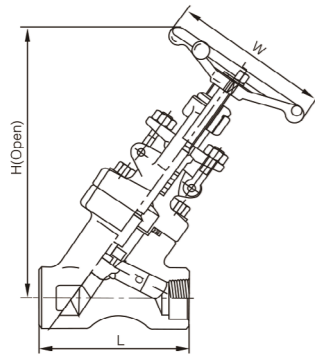

CL800 Bolted bonnet, full port & reduced port, outside screw and yoke(OS & Y)
Threaded, butt-welded or socket welded ends, design to BS5352

Specification (NPS)	R.P	-	1/2	3/4	1	1¼	1½	2	2½	3
	F.P	1/4	3/8	1/2	3/4	1	1¼	1½	-	-
Face to face(mm)	L	98	98	98	120	140	140	170	-	-
Handwheel diameter (mm)	W	100	100	100	125	160	160	180	-	-
Height(open)(mm)	H	180	180	180	188	280	280	295	-	-
Flow port dimension (mm)	d	7	9	13	17.5	23	30	35	-	-
weight(kg)		2.6	2.6	3.8	4.6	9.3	9.3	14	-	-

CL800 Welded bonnet, full port & reduced port, outside screw and yoke(OS & Y)
Threaded, butt-welded or socket welded ends, design to BS5352

Specification (NPS)	R.P	-	1/2	3/4	1	1¼	1½	2	2½	3
	F.P	1/4	3/8	1/2	3/4	1	1¼	1½	-	-
Face to face(mm)	L	98	98	98	120	140	140	170	-	-
Handwheel diameter (mm)	W	100	100	100	125	160	160	180	-	-
Height(open)(mm)	H	198	198	198	207	280	280	295	-	-
Flow port dimension (mm)	d	7	9	13	17.5	23	30	35	-	-
weight(kg)		1.8	1.8	2.0	3.5	8.0	8.0	12	-	-

CL900-CL1500 Bolted bonnet, full port, outside screw and yoke(OS & Y)
Threaded, butt-welded or socket welded ends, design to BS5352

Specification (NPS)	F.P	3/8	1/2	3/4	1	1¼	1½	2	2½
	Face to face(mm)	L	120	120	120	140	170	170	220
Handwheel diameter (mm)	W	100	125	125	160	160	180	200	-
Height(open)(mm)	H	175	175	215	215	254	305	305	-
Flow port dimension (mm)	d	9	12	15	20	28	32	40	-
weight(kg)		2.6	4.6	4.6	9.3	9.3	16	19.6	-

Forged Steel Globe Valve

FVF TECHNOLOGY CO., LIMITED



Y type globe valve

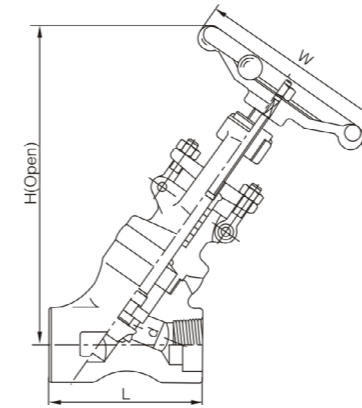

CL900-CL1500 Welded bonnet, full port, outside screw and yoke(OS & Y)
Threaded, butt-welded or socket welded ends, design to BS5352

specification (NPS)	F.P	3/8	1/2	3/4	1	1¼	1½	2	2½
	Face to face(mm)	L	120	120	120	140	170	170	220
Handwheel diameter (mm)	W	100	125	125	160	160	180	200	-
Height(open)(mm)	H	175	207	207	180	280	295	350	-
Flow port dimension (mm)	d	9	12	15	20	28	32	40	-
Weight(kg)		1.8	3.5	3.5	8.0	8.0	12	16	-

CL2500 Pressure seal bonnet, full port outside screw and yoke (OS & Y)
Socket welded ends, design conform to ASME B16.34

specification (NPS)	F . P	3/8	1/2	3/4	1	1¼	1½	2
	Face to face(mm)	L	186	186	186	186	232	232
Handwheel diameter (mm)	W	200	200	200	200	280	280	300
Height(open)(mm)	H	333	333	33	333	406	406	524
Flow port dimension (mm)	d	9	11	14	19	25	28	35
Weight(kg)		12.3	12.3	11.6	10.8	28.0	26.4	43.8

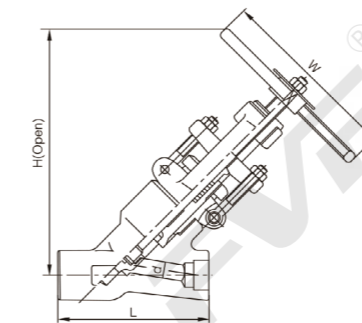

Forged Steel Globe Valve

FVF TECHNOLOGY CO., LIMITED



Flange and butt-welded globe valve

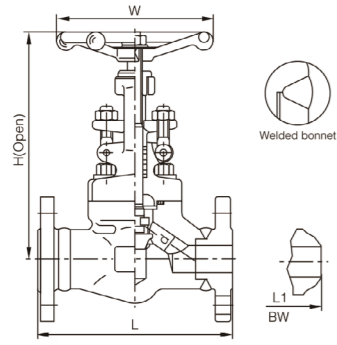

CL150-300-600 Bolted bonnet, reduced port, outside screw and yoke(OS & Y)
Flange or butt-welded, design to BS5352

Specification(NPS)		1/4	3/8	1/2	3/4	1	1¼	1½	2
Face to face(mm)	CL150	-	-	108	117	127	140	165	203
	CL300	-	-	152	178	203	216	229	267
	CL600	-	-	165	190	216	229	241	282
Handwheel diameter(mm)	W	-	-	100	100	125	160	160	180
Height (open)(mm)	CL150,CL300	-	-	180	184	217	224	260	300
	CL600	-	-	164	164	203	224	260	300
Flow port dimension(mm)	d	-	-	9	13	17.5	23	30	35
Weight (kg)	CL150	RF	-	3.45	4.00	6.19	9.6	10.5	17
		BW	-	2.3	3.6	7.8	8.2	12.0	15.0
	CL300	RF	-	3.8	5.1	7.2	12	13.5	19.7
		BW	-	2.8	4.0	8.5	9.2	12.6	16.8
	CL600	RF	-	5.6	7.8	12.5	17	23.5	38.8
		BW	-	3.4	4.7	9.2	10.5	13.3	18.9

CL900-CL1500 Bolted bonnet, full port, outside screw and yoke(OS & Y)
Flange or butt-welded, design to BS5352

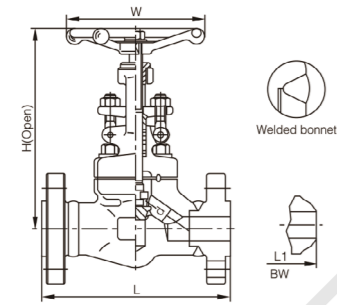

Specification(NPS)		1/4	3/8	1/2	3/4	1	1¼	1½	2
Face to face(mm)	L(RF),L1(BW)	-	-	216	229	254	279	305	368
	L(RTJ)	-	-	216	229	254	279	305	371
Handwheel diameter (mm)	W	-	-	125	125	160	160	180	200
Height(open)(mm)	H	-	-	207	207	230	160	300	355
Flow port dimension (mm)	d	-	-	12	15	20	28	32	40
Weight(kg)		-	-	11	13.2	17.4	19	24.5	31

CL2500 Pressure seal bonnet, full port, outside screw and yoke (OS &Y)
Welding flange or butt-welded design conform fo ASME B16.34

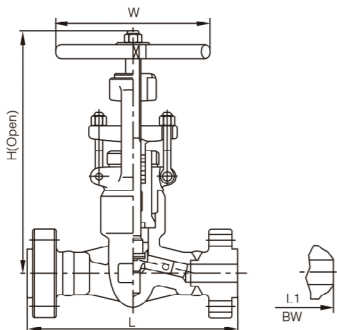

Specification(NPS)		1/4	3/8	1/2	3/4	1	1¼	1½	2
Face to face(mm)	L(RF), L1(BW)	-	-	264	273	308	349	384	451
	L(RTJ)	-	-	264	273	308	349	387	454
Handwheel diameter (mm)	W	-	-	200	200	280	280	280	300
Height(open)(mm)	H	-	-	320	320	320	440	440	490
Flow port dimension (mm)	d	-	-	11	14	19	25	28	35
Weight(kg)		-	-	21.5	24.7	3.4	48.1	58.1	130

Forged Steel Globe Valve

FVF TECHNOLOGY CO., LIMITED



Available actuation type

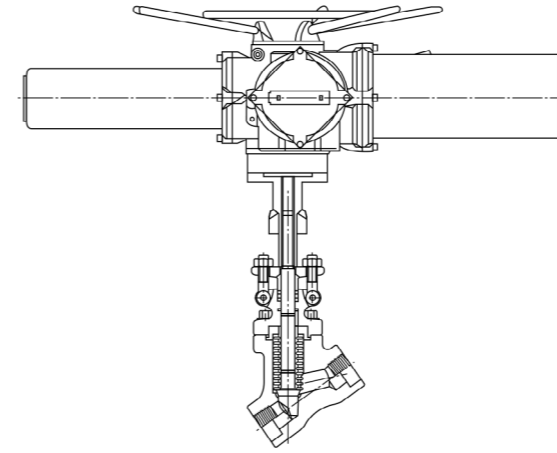

Electric actuator

CLALSS	Materials
150~2500	Carbon steel Stainless steel

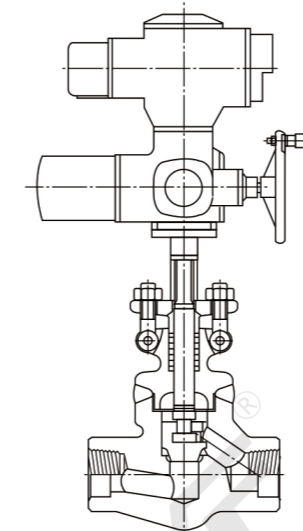

Electric actuator

CLALSS	Materials
150~2500	Carbon steel Stainless steel

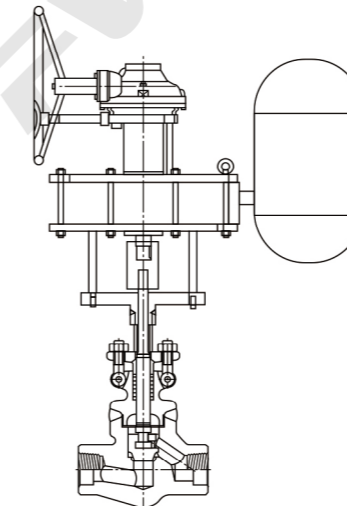

Pneumatic actuator

CLALSS	Materials
150~2500	Carbon steel Stainless steel

Forged Steel Globe Valve

FVF TECHNOLOGY CO., LIMITED



Note :

13 FORGED STEEL GLOBE VALVE

13

FORGED STEEL GLOBE VALVE

WWW.FLOWVALVEFITTING.COM

FVF®

13

Forged Steel Globe Valve

FVF TECHNOLOGY CO., LIMITED

